

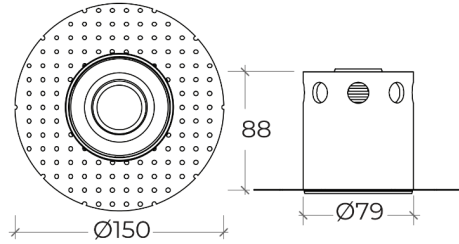

LANA-DL11228

6W TRIMLESS RECESSED DIRECTIONAL SPOTLIGHT



PRODUCT SPECIFICATIONS

Fixture Material	Die-cast aluminum
Trim Finish	Powder-coated white
Reflector/Lens	Anti-glare optical lens
Glass	Clear glass
Driver	External
Dimmability	Standard phase dimming. Also available in 0-10V and DALI dimming system
Binning	3 Step MacAdam
Life Span	50,000 hours

LED Chip	CREE COB
Input Voltage	180~240VAC, 50/60Hz
Color Rendering Index	>85
Driver Protection	Short circuit
Operating Temperature	-20° to 50°C
Warranty	5 years against manufacturing defects
Agency Approval	CE, RoHS
Weight	600g
Cut out	Ø80mm

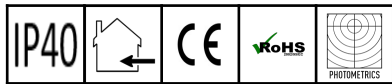

Power (W)	Available color Temperatures	LED Chip Lumen Efficacy			Power Factor	Available Beam Angles
		3000K	4000K	6000K		
6W	2700K 3000K 4000K 6000K	80lm/W	85lm/W	90lm/W	> 0.8	13° 24° 36° 60°

Standard option.

Non-standard products may be subject to MOQ. Contact your regional sales representative for more information.