



INSTALLATION INSTRUCTION

FS330005

Important Instructions. Please read first.

- Please follow instructions carefully. Failure to do so will void the warranty. Please ensure installation complies with local law and applicable standards.
 1. Only use a GLP power supply unit.
 2. Ensure correct input voltage is supplied to the luminaire.
 3. Ensure the power is disconnected before making any connections.
 4. Do not make modification nor alter the luminaire without written approval from GLP.
 5. Ensure to keep luminaire in a clean area free of debris.

INSTALLATION

- **Step 1:** Find a location where the luminaire has to be installed. Install a suitable wiring from the power supply (24VDC) to the luminaire. Do not exceed 30 meter distance between power supply and luminaire. Keep the power supply (24V DC) inside a junction box or mount it on the wall in a DB box.
- **Step 2:** Mount the aluminum channel onto a hard surface using silicon or stainless steel screws as illustrated.

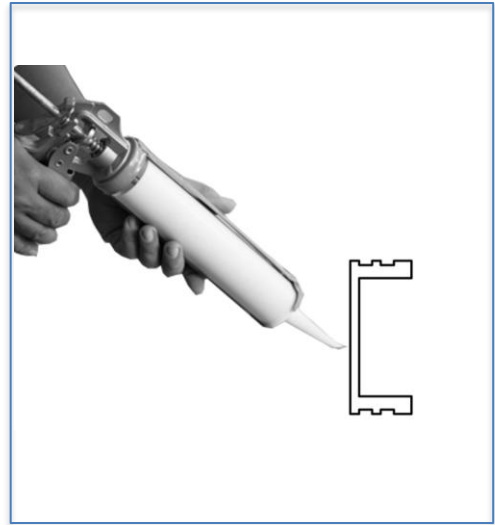

- **Step 3:** Remove the 3M tape from the luminaire.

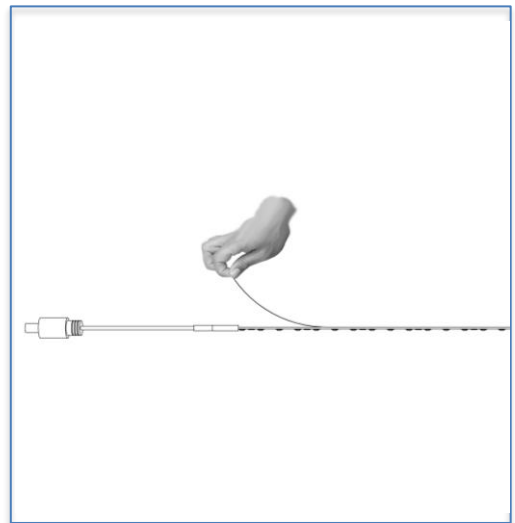



- **Step 4:** Stick the luminaire on the aluminum channel. Connect the luminaire power cable to the power supply (24VDC). For connection, use either male connector or cut the female connector from luminaire and connect to the power supply, solder the connections and wrap with electrical tape.. Please make sure the luminaire and power supply polarities are matching.

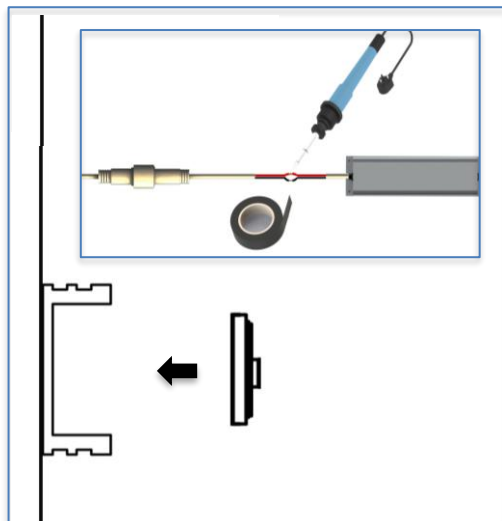
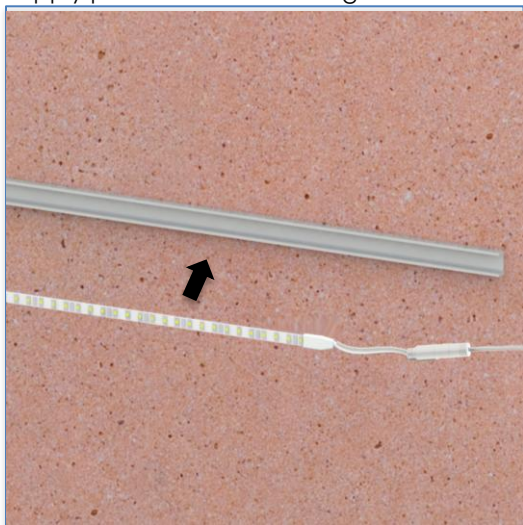

- **Step 5:** Fix the diffuser back on the aluminium channel.

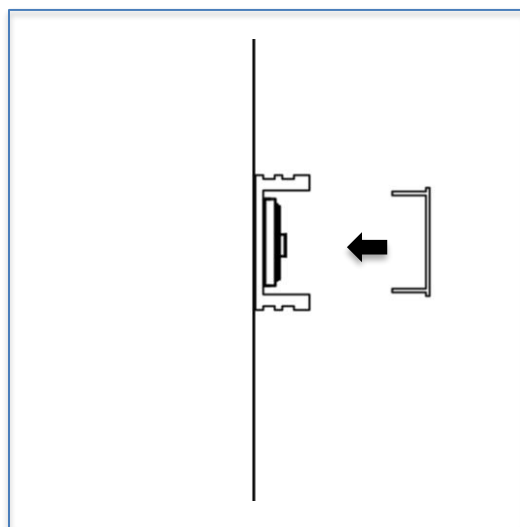



STRIPLIGHT CUTTING & JOINING

- **Step 1:** Cut the strip light through the marking.

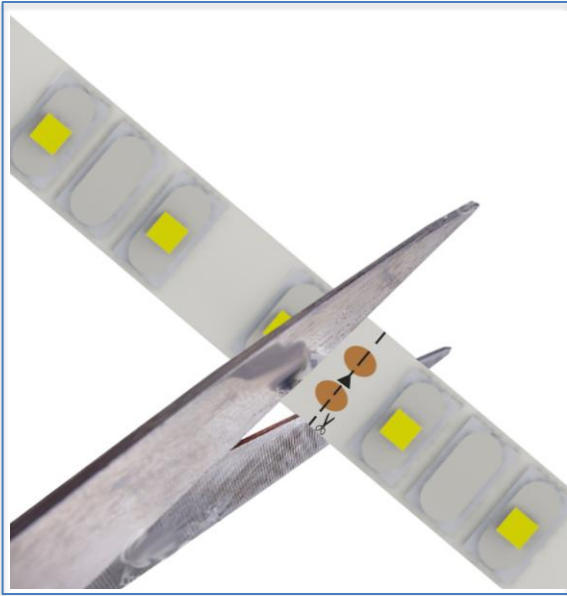

- **Step 2:** Remove the silicon from the cut region using a clean blade or knife

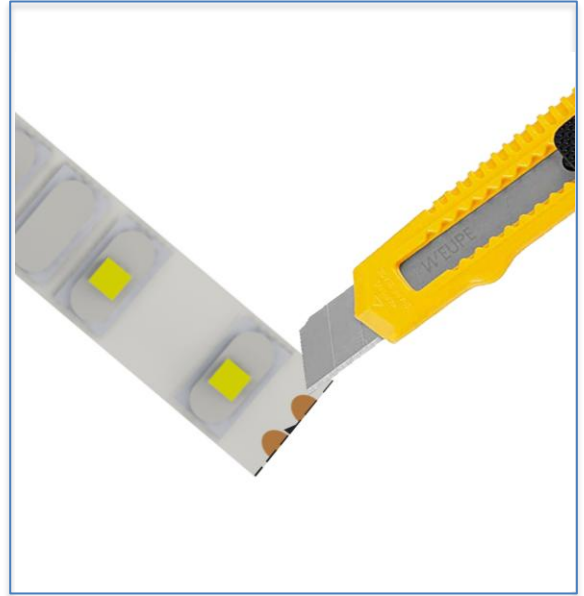

- **Step 3:** Solder the wire on the terminals marked on the strip light. Please make sure the polarities are matching.

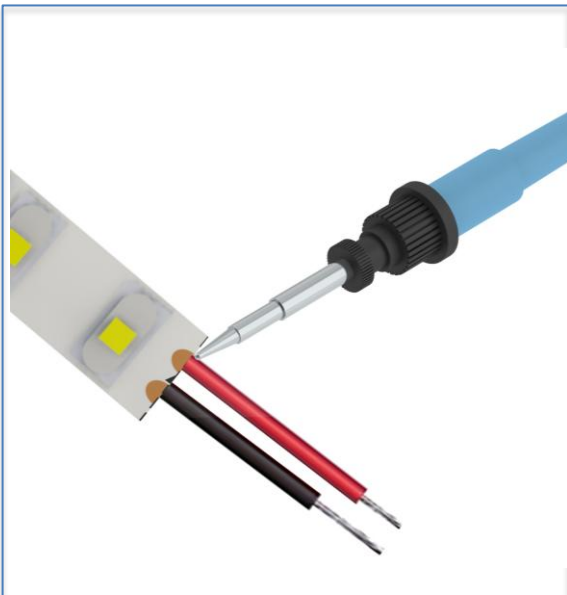

- **Step 4:** Fill silicone inside the end cap and insert it properly .

