



INSTALLATION INSTRUCTIONS

DL110329

Important Instructions. Please read first.

- **Please follow instructions carefully. Failure to do so will void warranty. Please ensure installation complies with local law and applicable standards.**
 1. Ensure correct input voltage is connected to the luminaire.
 2. Ensure the power is disconnected before making any connections.
 3. Do not make modification or alter the luminaire without written approval from GLP.
 4. Ensure to keep luminaire in a clean area free of debris.

INSTALLATION

- **Step 1:** Find the location where the luminaire has to be installed. Install a suitable wiring from the main supply (180-250V AC, 50/60Hz) to the luminaire.
- **Step 2:** Make the cutout on the ceiling as per the luminaire cut size.

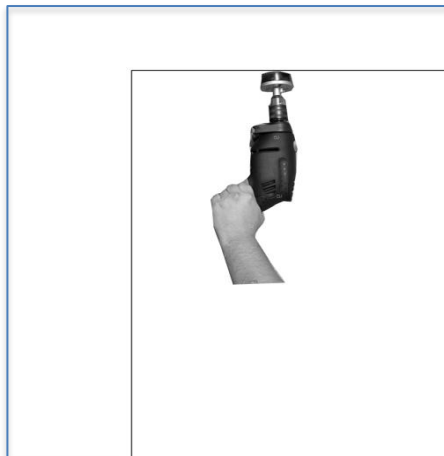

- **Step 3:** Take out the main supply cable through the hole.

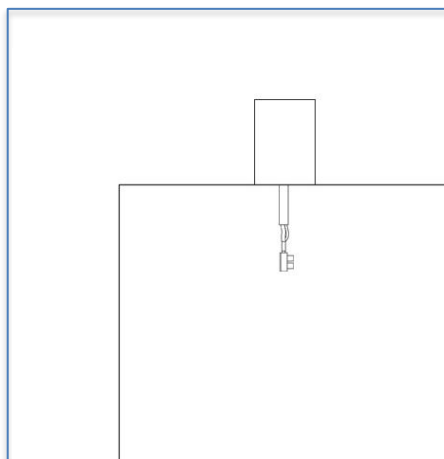
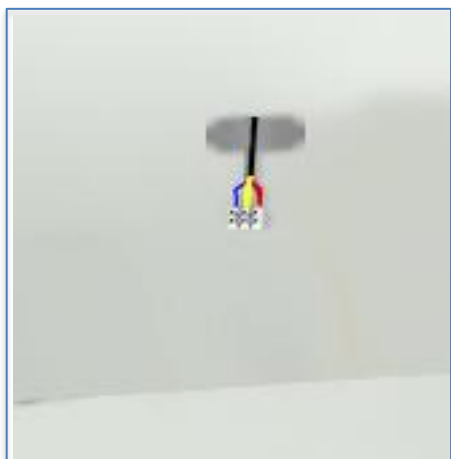

All the Installation and Maintenance must be done by Technicians and Professional Engineers



- **Step 4:** Connect the driver input to the main supply using terminal blocks or connectors. Wrap the connections with electrical tape . Make sure the driver output is properly connected to the luminaire.

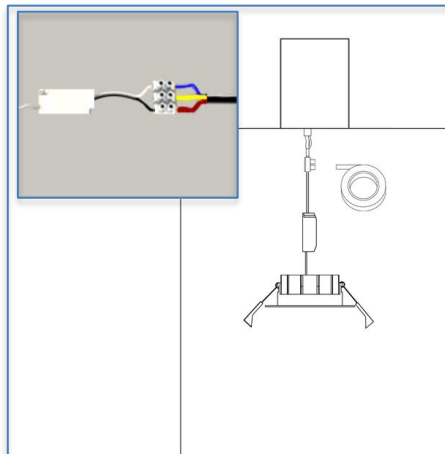

- **Step 5:** Fix the luminaire properly on the ceiling.

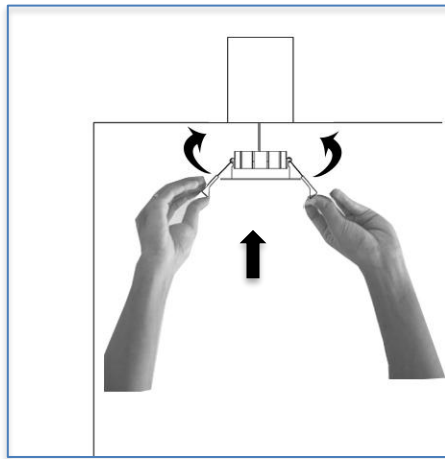
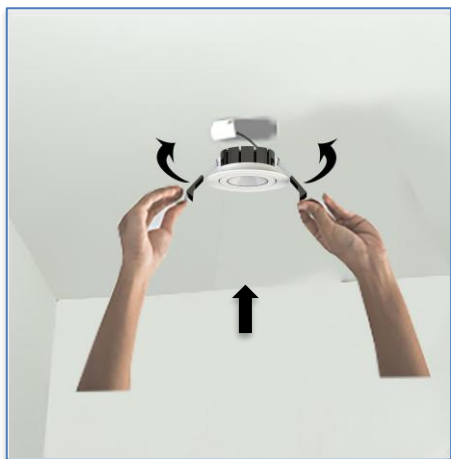

Make sure the main power is switched off during installations.

All the Installation and Maintenance must be done by Technicians and Professional Engineers