

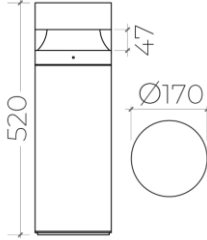

ARGI-BL220665

20W ROUND BOLLARD LIGHT



PRODUCT SPECIFICATIONS

| | |
|------------------|--|
| Fixture Material | Die-cast Aluminium |
| Fixture Finish | Powder-coated Black |
| Glass/Diffuser | Clear Polycarbonate Glass |
| Driver | Built-in |
| Binning | 3 Step MacAdam |
| Wiring | 1 meter of 3 core 1.5 mm ² rubber cable |
| Life Span | 50,000 hours |

| | |
|-----------------------|---------------------------------------|
| LED Chip | CREE |
| Power Consumption | 20W |
| Input Voltage | 180~240V AC, 50/60Hz |
| Operating Temperature | from -20° to 65° C |
| Color Rendering Index | >80 |
| Driver Protection | Short circuit |
| Warranty | 3 years against manufacturing defects |
| Agency Approval | CE, RoHS |

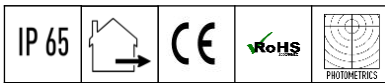

| Power (W) | Available color Temperatures | Lumen Efficacy | | | IP Rating | Available Beam Angles |
|-----------|----------------------------------|----------------|---------|---------|-----------|-----------------------|
| | | 3000K | 4000K | 6000K | | |
| 20W | 2700K 3000K 4000K 6000K | 95lm/W | 100lm/W | 110lm/W | 65 | 120° |

Standard option.

Non-standard products may be subject to MOQ. Contact your regional sales representative for more information.